

project	CRUISEPORT BOSTON		
location	BOSTON, MA	client	MASSPORT
architect	Stephen Moore w/ ARCHITERRA	contractor	N/A
project type	ARCHITECTURE, INTERIOR DESIGN		

improve passenger flow
 fluidity through space planning
 visual links to vintage Boston

re-branding

Massport was looking to upgrade and enhance the facility for the cruise-shipping industry in South Boston with a re-branding, up-grading exercise. A REVIT (BIM) model was used to investigate and create design presentations. The presentations were well-received enough to be implemented over the course of several months within the cruise season of 2009.

Stephen Moore helped synthesize the proposed concept included a new marquis design and super-graphic naming on the south elevation of the building on the old steel stanchions. Interiors were investigated to improve passenger flow and experience. Super-graphic panels of antique cruise ship posters and scenes of Boston were added, and ADA and code upgrades were proposed - including a new elevator and all new finishes and way finding signage.

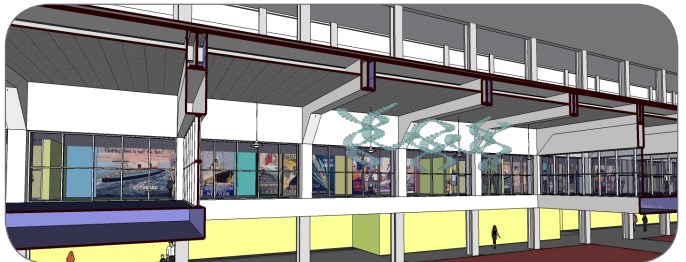

(Stephen Moore performed this work while with Architerra)

